

# amir prestige



## 27 Summerland Key BROADBEACH WATERS QLD

5 🏠 3 🚗 2 🚗

Reward yourself with a family-friendly entertainer everyone will adore with this five-bedroom, tri-level modern masterpiece. 4 years young and designed to perfection by award-winning architect, Bayden Goddard, not only does it maximise every inch of the 587m<sup>2</sup> block, but its anchored on an expansive three-way water junction, ensuring your aquatic views stretch far and wide.

Exceptionally low maintenance indoors and out (meaning busy families can reclaim their weekends), its showcased by a well-designed floorplan with ample natural light and quality finishes. Hosting guests is effortless, with a superior kitchen with oversized Smeg oven, butlers pantry and servery window plus a choice of areas to gather in. An open plan living and dining zone offers a seamless integration to the waterfront terrace where multiple zones for entertaining await, draped against Broadbeach skyline

**Building Size** : 59 sqm  
**Land Size** : 587 sqm  
**View** : <https://www.amirprestige.com.au/sale/ql/gold-coast/broadbeach-waters/residential/house/7253281>



**Amir Mian**  
07 5555 1600

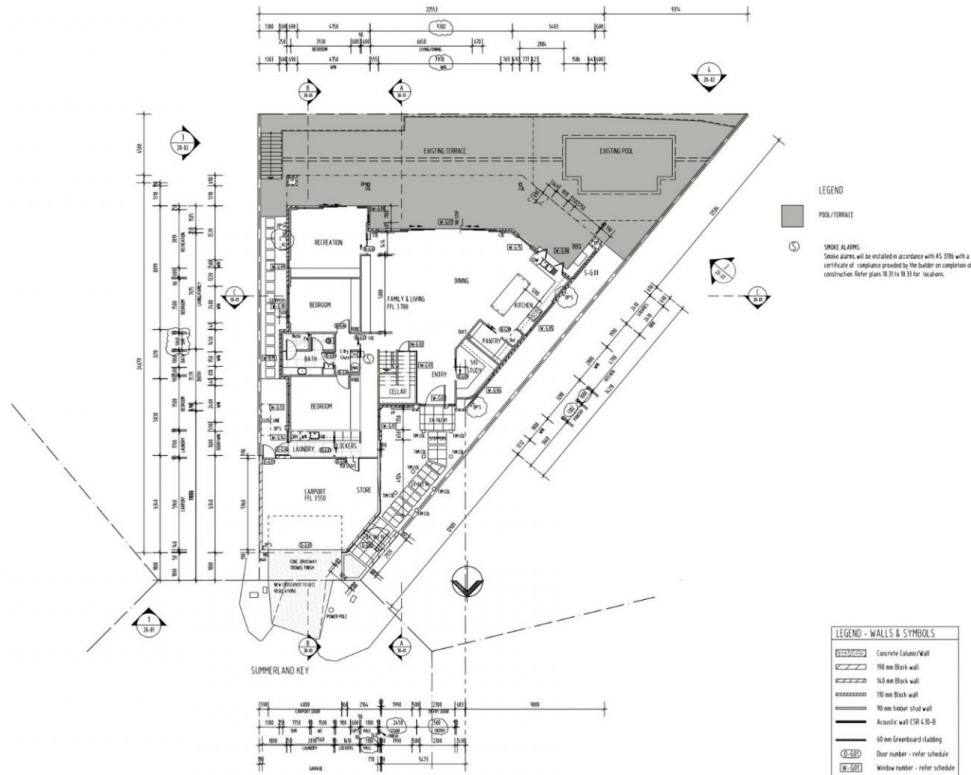

REV	DATE	BY	DESCRIPTION
1	10/10/2018	JP	CONSTRUCTION CASE
2	10/10/2018	JP	LOAN APPROVAL
3	10/10/2018	JP	LOAN APPROVAL
4	10/10/2018	JP	LOAN APPROVAL
5	10/10/2018	JP	LOAN APPROVAL
6	10/10/2018	JP	LOAN APPROVAL
7	10/10/2018	JP	LOAN APPROVAL
8	10/10/2018	JP	LOAN APPROVAL
9	10/10/2018	JP	LOAN APPROVAL
10	10/10/2018	JP	LOAN APPROVAL

  

CLIENT	
PROJECT	27 SUMMERLAND KEY, BROADBEACH WATERS
DRAWING TITLE	GROUND PLAN
SCALE	1:100 (A1)
DATE	10/10/18
DRAWN	JP
CHECKED	BP
JOB NO	532
DRAWING NO	WD-10-01
REVISION NO	0

DO NOT SCALE FROM DRAWING. VERIFY ALL DIMENSIONS ON SITE.

**LEGEND - WALLS & SYMBOLS**

- Concrete Column/Wall
- 100 mm Block wall
- 100 mm Brick wall
- 100 mm Timber stud wall
- Acoustic wall CSR L30-B
- 50 mm Greenboard Cladding
- Door number - refer schedule
- Window number - refer schedule

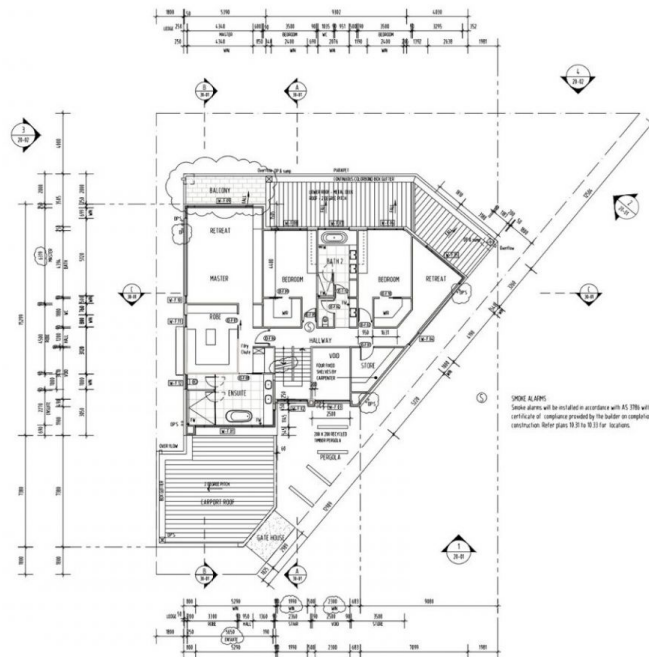

REV	DATE	BY	DESCRIPTION
1	10/10/2018	JP	CONSTRUCTION CASE
2	10/10/2018	JP	LOAN APPROVAL
3	10/10/2018	JP	LOAN APPROVAL
4	10/10/2018	JP	LOAN APPROVAL
5	10/10/2018	JP	LOAN APPROVAL
6	10/10/2018	JP	LOAN APPROVAL
7	10/10/2018	JP	LOAN APPROVAL
8	10/10/2018	JP	LOAN APPROVAL
9	10/10/2018	JP	LOAN APPROVAL
10	10/10/2018	JP	LOAN APPROVAL

CLIENT	
PROJECT	27 SUMMERLAND KEY, BROADBEACH WATERS
DRAWING TITLE	FIRST PLAN
SCALE	1:100 (A1)
DATE	10/10/18
DRAWN	JP
CHECKED	BP
JOB NO	532
DRAWING NO	WD-10-02
REVISION NO	0

DO NOT SCALE FROM DRAWING. VERIFY ALL DIMENSIONS ON SITE.