

amir prestige



136 Tarata Road GUANABA QLD

6  **4**  **6** 

Dreaming of an idyllic tree-change, where you can bask in endless space and tranquillity, and one that boasts enough space for two families? Gather your family and retreat to a rural paradise where seclusion and serenity prevail. Situated in the centre of this 7 acre parcel of land and at the end of a fully paved driveway, this sprawling, architecturally designed and northeast facing home will instantly impress.

Light-filled and infused with warmth from gleaming timber floors, revel in the multitude of living and dining zones on offer, with a two-way brick fireplace servicing both the formal and informal living areas. A small step leads to the fresh and modern 2pac and granite kitchen with stainless steel appliances, a walk-in pantry and an island bench for easy meal preparation. The luxury of space continues with the sophisticated and soulful master suite, complete with

Land Size : 28200 sqm
View : <https://www.amirprestige.com.au/sale/qld/gold-coast/guanaba/residential/acreagesemirural/7253491>

<https://www.amirprestige.com.au>
Gold Coast Luxury Real Estate

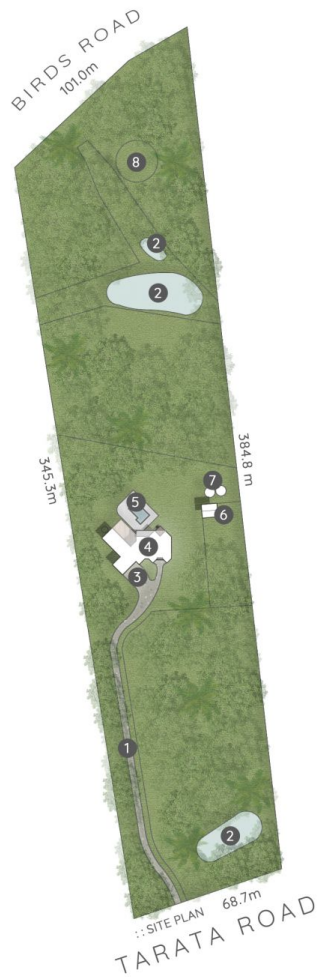

amir prestige
PROPERTY AGENTS

Jeanette Schmidt
0418 665 277

136 Tarata Road
GUANABA

2.83 Hectares
or 7.0 Acres

7 Bed + Study

4 Bath

5+ Car + Off-Street

Internal 422m²

Covered Externals 120m²

Total 542m² or 58 Squares

Workshed 42m²

puredesign plans for
CONCEPTS purpose

This is not a legal document therefore all measurements and information provided is subject to survey. No permission is given to use or alter this Floor Plan without the consent of Pure Design Concepts. The overall presentation style, layout, imagery, fonts, background, colours and terminology has been originally created by PDC and is subject to strict copyright. No ownership is taken of building design. Find out more at puredesignconcepts.com.au