

amir prestige



23 Queen Guineveres Place Sovereign Islands QLD

5 🏠 4 🚗 6 🚗

The owners have already moved on, so their remarkable waterfront sanctuary is now available for the discerning buyer who craves both grandeur and tranquility. Nestled on a sprawling 700m² lot with an impressive 29.1m of pristine waterfront, this home is a rare blend of timeless architecture and modern luxury.

From the moment you step into the grand entrance, where a sparkling chandelier cascades from a 5.5m ceiling and is embraced by an elegant dual staircase, you'll know you've entered something truly special. This estate is designed for effortless living and high-end entertaining, featuring a chef's kitchen, wet bar, and open-plan dining and living area that flows seamlessly onto a breathtaking waterfront terrace. With an infinity-edge pool, outdoor kitchen, and

Type : House
Price : Contact Agent
Building Size : 710 sqm
Land Size : 700 sqm
View : <https://www.amirprestige.com.au/sale/qld/gold-coast/sovereign-islands/residential/house/8175365>

[For full version visit the website](#)



Alister Billingsley
0419 795 219



Jeanette Schmidt
0419 665 277

<https://www.amirprestige.com.au>
Gold Coast Luxury Real Estate

23 Queen Guineveres Place PARADISE POINT

amir prestige
GROUP

Block Size 700m² | 5 Bedrooms | 4 Bathrooms | 6 Car
Internal 555m² | External 155m² | Total 710m² or 76 Squares

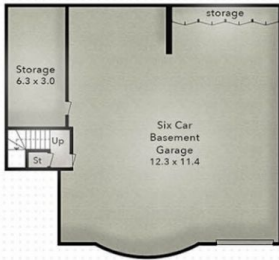

FLOOR PLAN
// Lower Floor

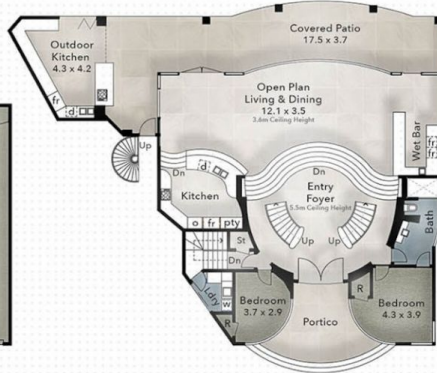

FLOOR PLAN
// Ground Floor

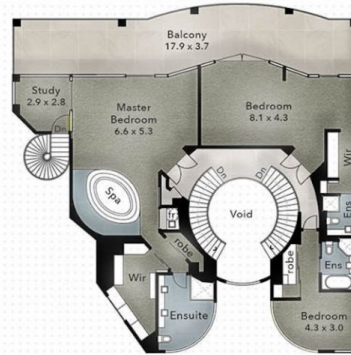

FLOOR PLAN
// First Floor

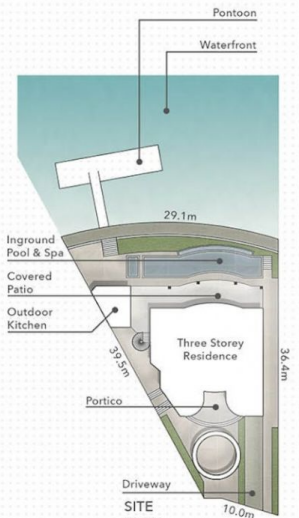

SITE PLAN
QUEEN
GUINEVERES
PLACE

pure design
CONCEPTS

Market Your Property Beautifully with puredesignconcepts.com.au

PURE DESIGN CONCEPTS ACCEPTS NO OWNERSHIP OR AUTHORSHIP OF THE ABOVE DESIGN. DRAWINGS ARE AN INTERPRETATION ONLY FOR THE BENEFIT OF MARKETING PURPOSES. ALL MEASUREMENTS ARE APPROXIMATE. INDIVIDUALS SHOULD RELY ON THEIR OWN INFORMATION.

⊕ NORTH