

amir prestige



601/388 Marine Parade Labrador QLD

2  2  1 

Welcome to Apartment 601 at Coast North, where luxury meets coastal charm. This refined 2-bedroom, 2-bathroom residence captures the essence of Gold Coast living in an exclusive, residential-only building, steps from the Broadwater. Revel in sweeping north-facing water views and premium finishes that set this apartment apart.

Step inside to discover an expansive open-plan living and dining area that flows onto a large balcony with panoramic Broadwater vistas. The chef's kitchen, complete with stone benchtops, Smeg gas cooktop, stainless steel appliances, and soft-close cabinetry, is a perfect blend of form and function. Sunlight and coastal breezes enhance the natural warmth and inviting ambiance throughout.

Type : Apartment
Price : Just Listed!
Building Size : 131 sqm
View : <https://www.amirprestige.com.au/sale/ql-d/gold-coast/labrador/residential/apartment/8179734>

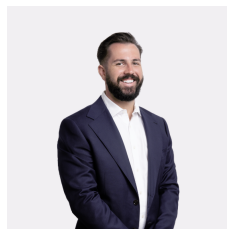

Mitch Booth
0406 353 437

[For full version visit the website](https://www.amirprestige.com.au)

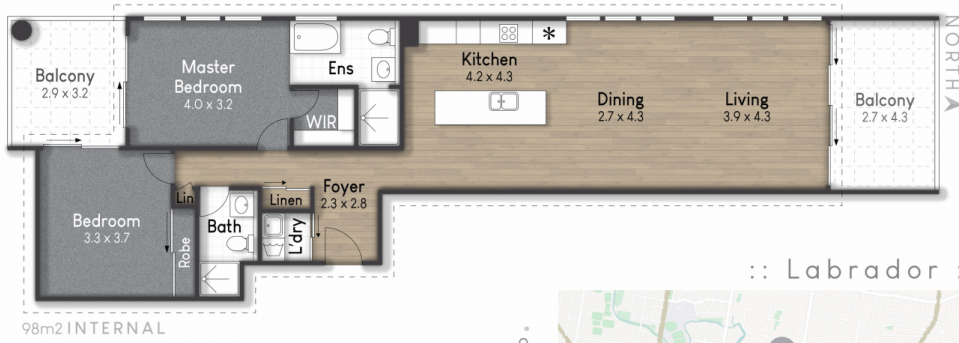

Location Map Legend

- 1. Residence
- 2. Sea World
- 3. Harbortown Shopping Centre
- 4. Wave Break Island
- 5. The Spit: Southport

• LOCATION MAP •



:: Labrador ::

:: Bradford Street ::

388 Marine Pde, Labrador

BED 2 BATH 2 CAR 1

Internal: 109m² | External: 22 m² | Approx Total: 131 m²

amir prestige

Whilst every attempt has been made to ensure the accuracy of the floor plan contained here, measurements of doors, windows, rooms and any other item are approximate and no responsibility is taken for any error, omission, or misstatement. This plan is for illustrative purposes only and should only be used as such by any prospective purchaser.

